

NOTE:

- CUT CLUTCH WIRES AT 215mm LENGTH
- FITTINGS END SUPPLIED WITH PLASTIC CAPS
- USE 5.5LB/FT TIGHTENING TORQUE TO MOUNT ITEM #3 ONTO ITEM #5
- USE 30LB/FT TIGHTENING TORQUE FOR ITEM #13 ON MOUNTING



PLACE O-RING IN BAG, ZIPPED & TIED UP TO THE COMPRESSOR
 *- (PRIOR TO INSTALL #20 HOSE LUBRICATE O-RING WITH POE OIL)

16	2	31-1266	PED Term. (not shown)
15	2	31-1131	PED Seal (not shown)
14	1	31-1068	PED WP 2-Way CONN
13	4	29-1190	M10x40 HEX BOLT
12	4	29-0961	LOCK WASHER M10
11	2	29-0449	M5x10 YELL. CROM. TAP.
10	1	27-2885	FITTING ASSY. #20 ORS
9	1	27-2746	COMPRESSOR FITTING
8	1	27-1744	O-RING ORS #20
7	1	27-0520	HOSE CLAMP #14
6	1	27-0502	HOSE CLAMP #10
5	1	26-1508	COMPRESSOR
4	1	25-2340	+12V COIL ASSY.
3	1	25-2334	PRESSURE SWITCH ASSY.
2	1	25-2312	WIRING HARNESS
1	1	24-10697	MOUNTING BRACKET

SYM	PCS	PART NO.	DESCRIPTION
-----	-----	----------	-------------

REV	DESCRIPTION	DATE	BY
4	REVISED PER ECN #5791	OCT 10/08	JR
3	REVISED PER ECN #5391	OCT 04/07	JR
2	REVISED PER ECN #5379	OCT 04/07	JR
1	REVISED PER ECN #PRC	AUG 16/07	JR

TOLERANCE UNLESS OTHERWISE SPECIFIED

ANG	0.5	3	6	30	120	315	1000	OVER
	±0.15	±0.2	±0.5	±0.8	±1.2	±2	±3	±4

THIS POINT IS PROVIDED ON A RESTRICTED BASIS AND IS NOT TO BE USED IN ANY WAY DETRIMENTAL TO THE INTEREST OF MOBILE CLIMATE CONTROL.

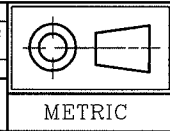

CHECKED: *[Signature]* DATE: Oct 14/08

MCC Mobile Climate Control Inc.
 Toronto - Ontario - Canada

26-1509E
 COMPRESSOR ASSY.
 12V

SCALE: NTS BY: JR
 DATE: 8/14/2007
 DWG. REV: 26-1509E.idw 4