

THIS DRAWING/DESIGN IS STRICTLY CONFIDENTIAL & THE
 COPYRIGHT THEREIN THE EXCLUSIVE PROPERTY OF
MOBILE CLIMATE CONTROL INC.
 AND MAY NOT BE USED OR COPIED OR EXHIBITED WITHOUT
 THEIR WRITTEN PERMISSION.

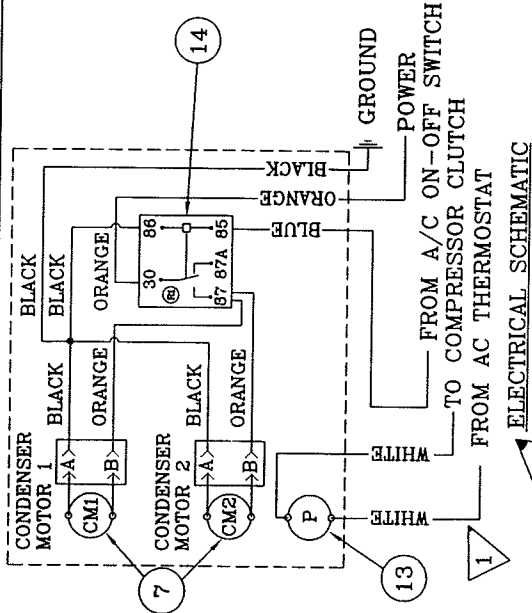

ELECTRICAL SCHEMATIC

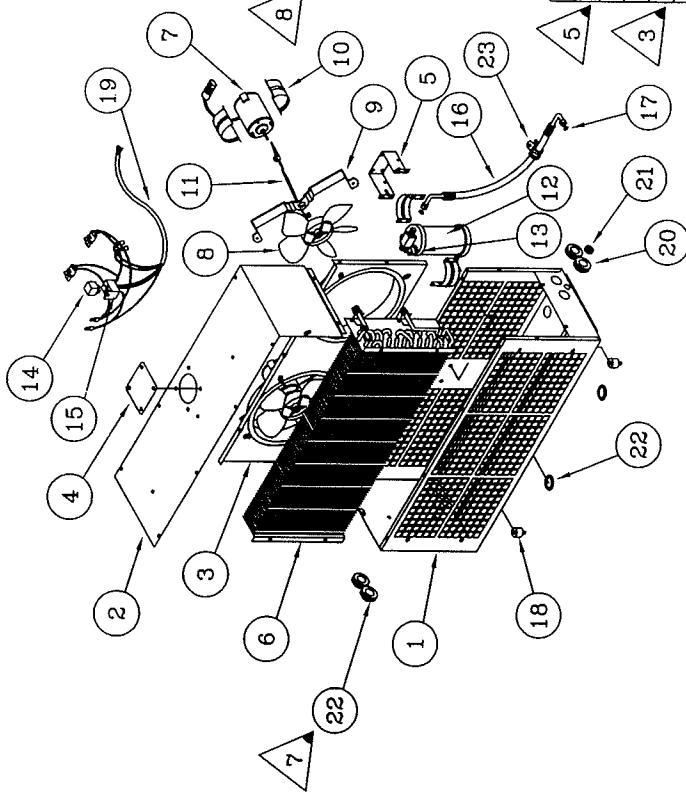

STRIP ENDS OF
 WIRES .25

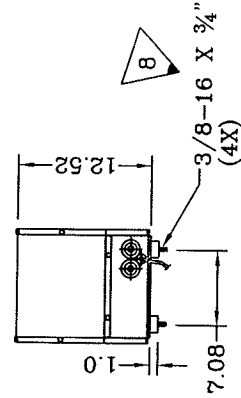
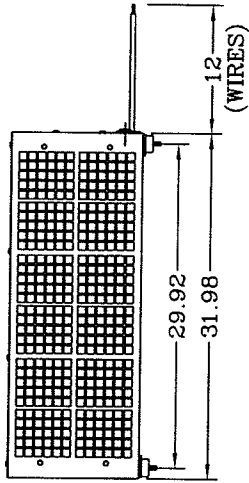

SPECIFICATIONS:

CAPACITY - TO SUPPORT A COOLING CAPACITY
 OF 41600 BTU/H (AT 79 FWB)
 AIR FLOW - 1900 CFM
 CURRENT - 24 AMPS /13.5V
 WEIGHT - 65 LBS

CASING MADE OF 16GA CRS AND FINISHED
 IN BLACK SEMI-GLOSS POWDER COAT.

INLET - 3/4-16 UNF MALE #8 O-RING
 OUTLET - 5/8-18 UNF MALE #6 O-RING

23	1	27-0012	HOSE CLAMP #6
22	4	28-0013	SNAP IN PLUG
21	2	28-0045	GROMMET
20	2	28-0005	GROMMET
19	1	25-1064	WIRING HARNESS
18	4	28-0057	VIBRATION MOUNT
17	2	27-0601	O-RING #6
16	1	27-0379	REFRIGERANT HOSE #6
15	1	25-0221	SOCKET/RELAY
14	1	25-0251	RELAY 12V
13	1	25-0308	PRESSURE SWITCH
12	1	26-0219	RECEIVER DRIER
11	4	24-0962	MOTOR SUPPORT
10	6	24-0234	MOUNT
9	2	24-0963	MOTOR BRACKET
8	2	25-0302	FAN
7	2	25-0470	MOTOR 12V
6	1	21-0188	CONDENSER COIL
5	1	24-0929	RECEIVER DRIER BKT.
4	1	24-0928	COVER PLATE
3	1	24-0927	FAN MOUNTING PLATE
2	1	24-0926	COVER
1	1	24-0925	CASING

SYM	POS	PART NO.	DESCRIPTION
		14-1001	CONDENSER 12V

CHECK BY: *WJ* DATE: 7/8/04
 SCALE: NTS
 DATE: OCT 16, 1996
 DWG: P3-4167 REV: 8

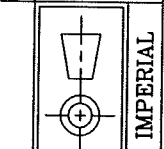

8	REVISED PER ECN #4193	MAY 25/04	BY
7	REVISED PER ECN #3913	SEP 25/03	IK
6	REVISED PER DCR #2902	AUG 02/01	DA
5	REVISED PER DCR #2912	MAY 30/01	LY
SYM	DESCRIPTION	DATE	BY

THIS PRINT IS PROVIDED ON A RESTRICTED BASIS AND IS NOT TO BE USED IN ANY MANNER WITHOUT THE INTEREST OF MOBILE CLIMATE CONTROL INC.

Mobile Climate Control Inc.
 Toronto - Ontario - Canada