

THIS DRAWING / DESIGN IS STRICTLY CONFIDENTIAL & THE
 COPYRIGHT THEREIN THE EXCLUSIVE PROPERTY OF
MOBILE CLIMATE CONTROL INC.
 AND MAY NOT BE USED OR COPIED OR EXHIBITED WITHOUT
 THEIR WRITTEN PERMISSION.

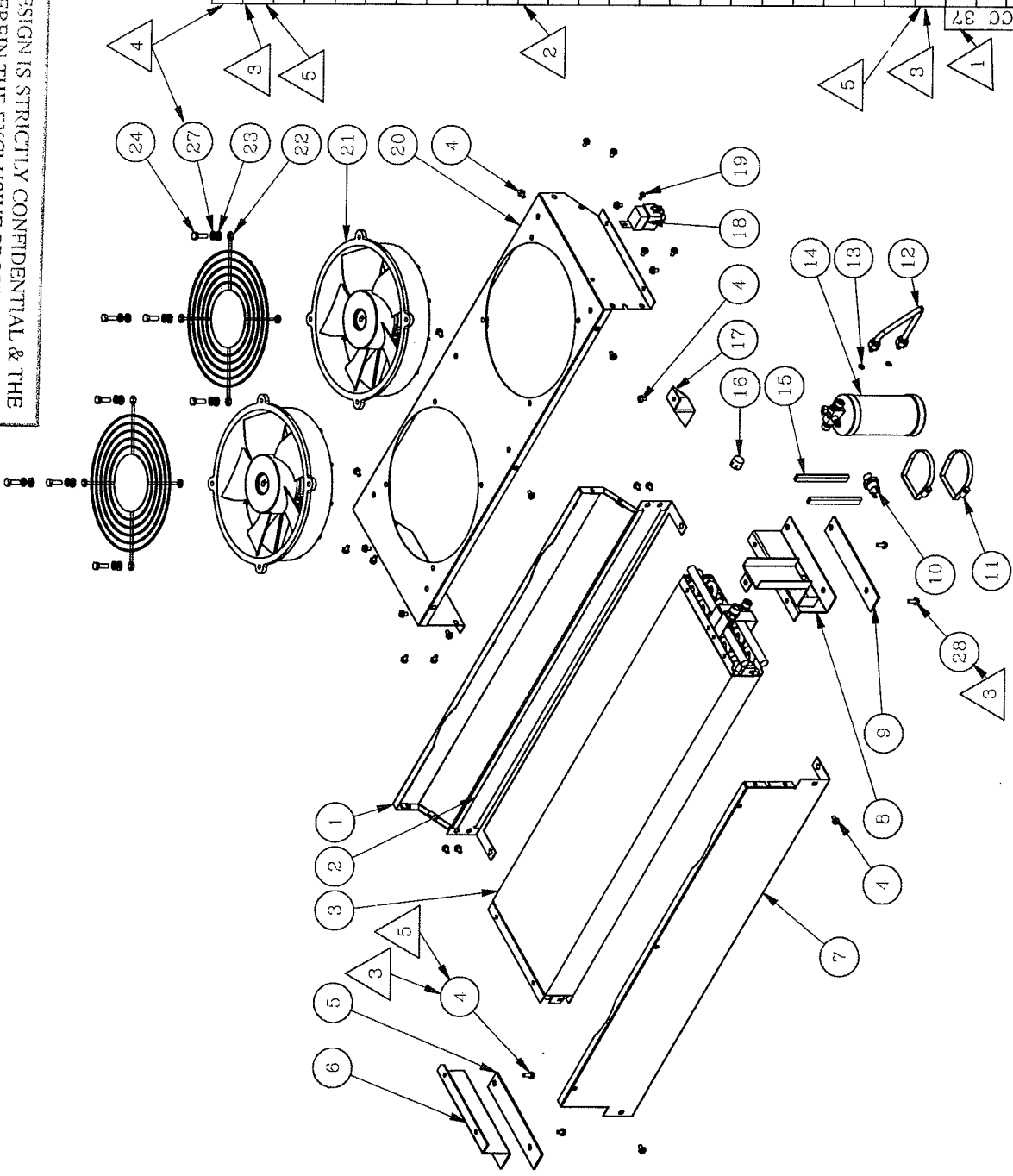

| SYM | PCS | PART NO. | DESCRIPTION |
|-----|-----|----------|------------------------|
| 27 | 8 | 29-0194 | M8 SPRING LOCK WASHER |
| 26 | | | |
| 25 | 1 | 25-1575 | W. HARNESS (NOT SHOWN) |
| 24 | 8 | 29-0401 | M8x25 BOLT |
| 23 | 8 | 29-0407 | M8 WASHER |
| 22 | 2 | 23-0148 | FINGER GUARD |
| 21 | 2 | 15-7505 | FAN ASSY 12V |
| 20 | 1 | 24-5858 | COVER |
| 19 | 1 | 29-0449 | M5x10 BOLT |
| 18 | 1 | 25-1459 | RELAY 12V |
| 17 | 1 | 24-6601 | RECEIVER BRACKET |
| 16 | 1 | 28-0348 | PLASTIC CAP #8 |
| 15 | 2 | 29-0002 | EDGE TRIM L=120 |
| 14 | 1 | 26-0220 | RECEIVER DRIER |
| 13 | 2 | 27-0601 | O-RING #6 |
| 12 | 1 | 34-2261 | COPPER TUBE 3/8" |
| 11 | 2 | 27-0183 | GEAR CLAMP |
| 10 | 1 | 25-0343 | PRESSURE SWITCH |
| 9 | 1 | 28-0835 | INSULATION 1 |
| 8 | 1 | 24-5859 | SUPPORT (L) |
| 7 | 1 | 24-5856 | FRONT PLATE |
| 6 | 1 | 24-5860 | SUPPORT (R) |
| 5 | 1 | 28-0835 | INSULATION 2 |
| 4 | 29 | 29-0450 | M6X10 BOLT |
| 3 | 1 | 21-0951 | CONDENSER COIL |
| 2 | 4 | NS-0002 | INS 3/16"x1/2"x865mm |
| 1 | 1 | 24-5857 | BACK PLATE |

CHECKED: *[Signature]* DATE: *Mar 17/08*

SCALE: NTS B1: GRG
 DATE: 10/11/2002
 DWG: 14-2105-E.idw 5

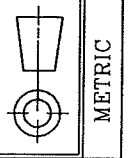

| SYM | DESCRIPTION | DATE | BY |
|-----|-----------------------|--------------|----|
| 5 | REVISED PER ECN #5596 | MAR 14/08 RL | |
| 4 | REVISED PER ECN #5536 | 01/29/08 INK | |
| 3 | REVISED PER ECN #3960 | DEC 03/03 | |
| 2 | REVISED PER ECN #3664 | MAR 24/03 RL | |

| REV | DATE | DESCRIPTION |
|-----|------|-------------|
| 5 | | REVISION |

| TOLERANCE UNLESS OTHERWISE SPECIFIED | OVER |
|--------------------------------------|-------|
| 0.5 | 1000 |
| 1 | 2000 |
| 1.5 | 3000 |
| 2 | 4000 |
| 3 | 5000 |
| 4 | 6000 |
| 5 | 7000 |
| 6 | 8000 |
| 7 | 9000 |
| 8 | 10000 |
| 9 | 11000 |
| 10 | 12000 |
| 11 | 13000 |
| 12 | 14000 |
| 13 | 15000 |
| 14 | 16000 |
| 15 | 17000 |
| 16 | 18000 |
| 17 | 19000 |
| 18 | 20000 |

THIS PRINT IS PROVIDED ON A RESTRICTED BASIS
 AND IS NOT TO BE USED IN ANY WAY DETRIMENTAL
 TO THE INTEREST OF MOBILE CLIMATE CONTROL

METRIC